

3000+Satisfied Customers



▶ **Justice Facilities**
18



▶ **Military Institutions**
51



▶ **Shopping malls**
30



▶ **Educational institutions**
722



▶ **Industrial Facilities**
532



▶ **Prisons**
5



▶ **Housing Projects**
214



▶ **Government Agencies**
490



▶ **Health Facilities**
210



▶ **Restaurants**
58



▶ **Leisure and Tourism Facilities**
639



▶ **Other Facilities**
60

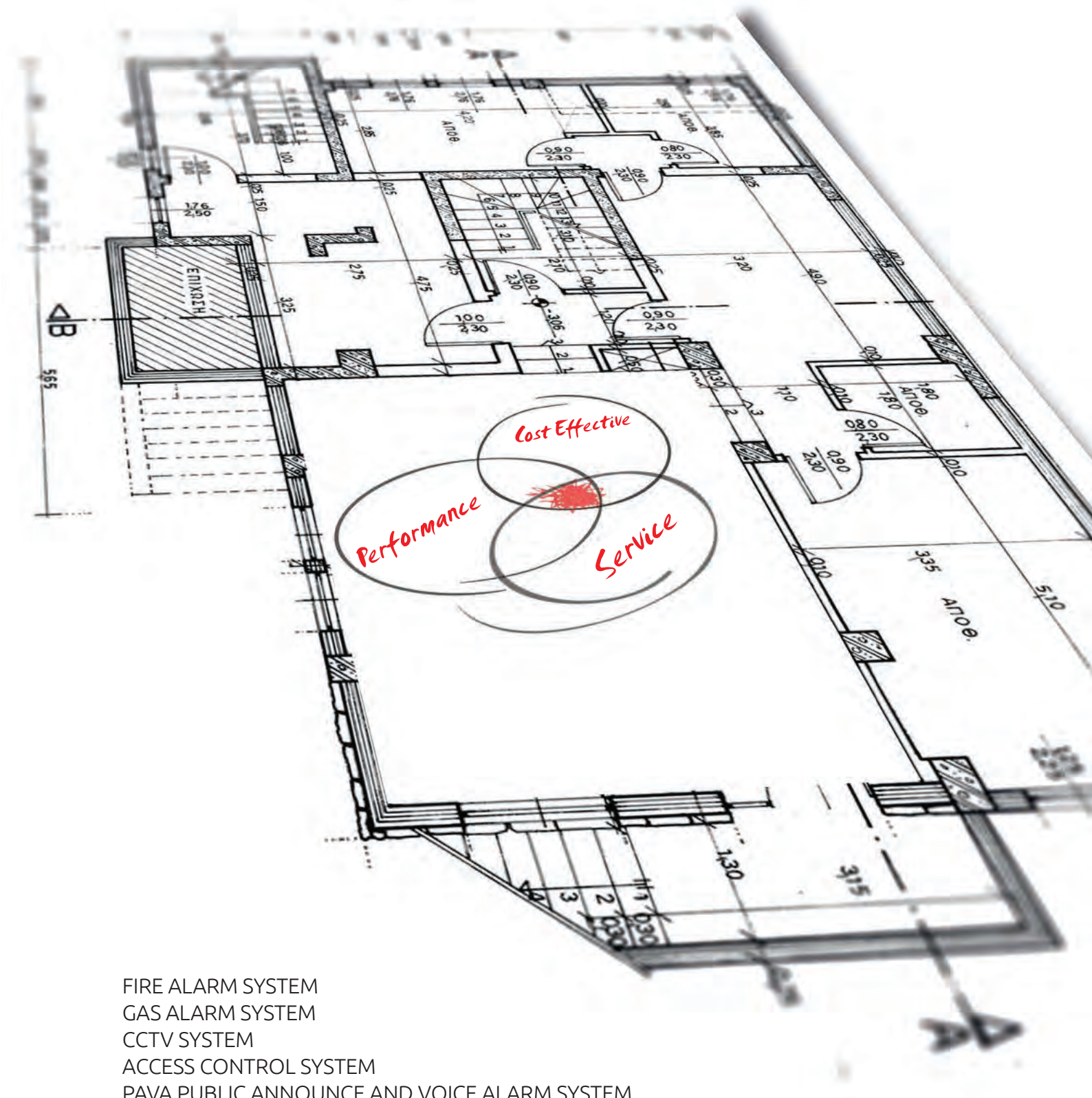

- FIRE ALARM SYSTEM
- GAS ALARM SYSTEM
- CCTV SYSTEM
- ACCESS CONTROL SYSTEM
- PAVA PUBLIC ANNOUNCE AND VOICE ALARM SYSTEM
- EMERGENCY LIGHTING SYSTEM
- WATER-LEAKAGE ALARM SYSTEM
- EXPROOF SYSTEMS
- BSM INTEGRATION SYSTEM
- AMC REMOTE MONITORING SOFTWARE

I-REM Fire and Security Limited

1st Floor office 41 east street Bromley BR1 1QQ

Accountant Mobile: +44 (782) 665 93 02 **Company Number:** 11960593

Director Mobile: +44 (755) 702 80 11 ▶ info@i-rem.co.uk

Landline: +44 (779) 873 32 91 ▶ www.i-rem.co.uk



FIRE ALARM SYSTEM

- ▶ VDS, LPCB, CERTIF, DEDAL, TSE and BSI approved
- ▶ Conventional, addressable and wireless options
- ▶ Maximum Sensitivity Without False Alarm
- ▶ Easy to use with Touch Screen panel
- ▶ Easy start up with isolator features
- ▶ Easy maintenance with a magnet test features



GAS ALARM SYSTEM

- ▶ LPG, LNG and CO gas detection
- ▶ Conventional and Addressable options
- ▶ Competible EN50194 and EN50291 standards
- ▶ IP55 protection class
- ▶ 3 different levels of gas detections
- ▶ Multi Language control panels



CCTV SYSTEM

- ▶ Maximum performance on Day and Night Mode
- ▶ IP and AHD solutions
- ▶ The right option for each environment
- ▶ Intelligent Video Analysis
- ▶ HD quality
- ▶ Easy to use with recording and end user interface



ACCESS CONTROL SYSTEM

- ▶ Aesthetic Designed readers
- ▶ TCP / IP and RS485 control unit
- ▶ Stand alone or network option
- ▶ Functional software
- ▶ 100,000 events memory
- ▶ A capacity up to 20,000 cards



PUBLIC ANNOUNCE VOICE ALARM SYSTEM

- ▶ EN54 compliant systems
- ▶ Fault alert and 1000 event logs
- ▶ Backup amplifier
- ▶ Backup power supply
- ▶ Fire-resistant loudspeakers
- ▶ Public Announce



EMERGENCY LIGHTING SYSTEM

- ▶ Single and double face options
- ▶ Long working life with a LED structure
- ▶ Easily test with a magnet
- ▶ 1 and 3 hour working options
- ▶ Suitable for surface and flush mount
- ▶ Long-life battery



WATER-LEAKAGE ALARM SYSTEM

- ▶ Design for humid environments
- ▶ Conventional and addressable options
- ▶ Optional relay and buzzer output
- ▶ IP24 protection class
- ▶ Wide sensing range with Cable type sensor
- ▶ CE approved



EXPROOF SYSTEMS

- ▶ Wired and wireless system options
- ▶ Atex and LPCB certified products
- ▶ Camera Systems
- ▶ Emergency Announcement Systems
- ▶ Fire alarm systems
- ▶ Gas Alarm Systems



BSM INTEGRATION SYSTEM

- ▶ Single or multi-point control monitoring
- ▶ Programming alarm and fault scenarios
- ▶ Graphical alarm, fault and address information
- ▶ Integration with every brand of camera system
- ▶ Monitoring from smartphones and tablets
- ▶ Compatibility with third party systems

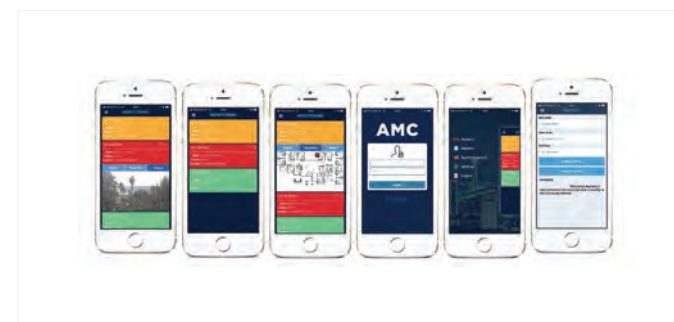

AMC REMOTE MONITORING SYSTEM

- ▶ Compatibility with every brand of fire alarm panel
- ▶ Display building information and route
- ▶ Display location information of alarm and fault
- ▶ Display Location risk information and camera
- ▶ Reporting maintenance Works
- ▶ Monitoring from smartphones, tablets, computers